

# KITSAP CONFERENCE CENTER

AT BREMERTON HARBORSIDE



## Meetings & Events

Our 10,000 square foot Bremerton waterfront event space is perfect for your next conference, banquet, or event. Located just steps from the Seattle-Bremerton ferry terminal with the 105-room Hampton Inn & Suites located across the plaza, and the 130-room Fairfield Inn & Suites nearby on 4th Street, the Kitsap Conference Center at Bremerton Harborside offers the perfect collection of flexible spaces for all types of meetings and events, in one convenient location.

Our entire staff is dedicated to ensuring that your next meeting or special event in Kitsap County is everything that you envision it to be. From the moment you walk in the door, the Kitsap Conference Center team provides the services you need every step of the way. From event planning to custom menus highlighting seasonal ingredients, our staff will handle all of the details to make sure your event is a success.

## Conference Meeting Package (CMP) Event Planning Made Simple...

The Complete Meeting Package (CMP) covers everything you need for your next event. This CMP is a per person and per day package that saves time by simplifying planning and budgeting. The CMP includes:

- Main meeting room
- Audiovisual equipment
- Continental breakfast
- Mid-morning refresher
- Buffet luncheon
- Mid-afternoon refresher
- Conference supplies
- Your personal conference planner



Full day CMP \$55.00 per person, service charge included.

## Event Package

### Host Your Next Meeting, Banquet or Social Event on Bremerton's Waterfront

Kitsap Conference Center at Bremerton Harborside has the ability to host events for groups from 10 to 750 people, making it the perfect venue for conferences, corporate parties, holiday functions, birthday, anniversary parties, and more. In addition to the Puget Sound Ballroom and Oyster Bay Room, we also offer the Fountain Room overlooking Harborside Fountain Park, one of the Puget Sound region's most impressive public spaces. Located on the waterfront, the park features five large copper-ringed fountains, modern sculptures, and lush landscaping.

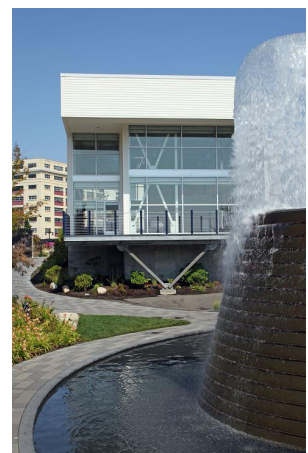

## Event Package (continued)

A Kitsap Conference Center room rental package offers you an easy way to calculate the cost of your event. Included in your room rental are the following items as appropriate for your event:

- Tables and chairs for guest seating
- Linens in a variety of colors
- All glass, china, and silverware
- Votive candles and floral bud vases for table decoration
- Up to an 8'x12' stage
- A 15'x15' dance floor
- Two easels
- Up to four clothed and skirted 8' tables
- A lobby attendant to greet and direct your guests



Puget Sound Ballroom - per section \$375

Puget Sound Ballroom - entire space \$1,500

Oyster Bay Room - \$275

*The above prices are subject to food and beverage minimums.*

## Menus

Kitsap Conference Center at Bremerton Harborside offers a wide variety of dining options utilizing the freshest seasonal ingredients. Our menus highlight local produce, seafood, and meats. Our team of culinary professionals is happy to customize any menu to suit your needs.

[View our Menus:](#)

[Breakfast](#) | [Lunch](#) | [Dinner](#) | [Hors d'oeuvres](#)

[Dessert](#) | [Wine and Bar](#) | [CMP Sample Menu](#)



## Capacity Chart / Floor Plan

Kitsap Conference Center offers a 6,000 square foot ballroom which is divisible by four breakout sections, and opens to the Sinclair Gallery with views of the Bremerton Harborside plaza and waterfront. Adjacent to the Conference Center is the Fountain Room, with views of the spectacular Harborside Fountain Park.

Click on a link below to view our floor plans.

Room	Sq. Ft.	Reception	Banquet	Theater	Classroom	Boardroom	U-Shape
Puget Sound Ballroom	6,000	600	500	660	340	-	-
Ballroom (3 Sections)	4,500	450	375	495	255	-	-
Ballroom (2 Sections)	3,000	300	250	330	170	-	-
Ballroom (1 Section)	1,500	150	125	165	85	46	43
Oyster Bay Room	1,000	100	80	100	60	30	36
Sinclair Gallery	2,240	225	-	-	-	-	-
Rotunda and Lobby	1,000	100	-	-	-	-	-
Fountain Room	1,650	200	120	130	75	46	42
Harborside Fountain Park	2.5 acres	500	-	-	-	-	-

Conference Center Floor Plan

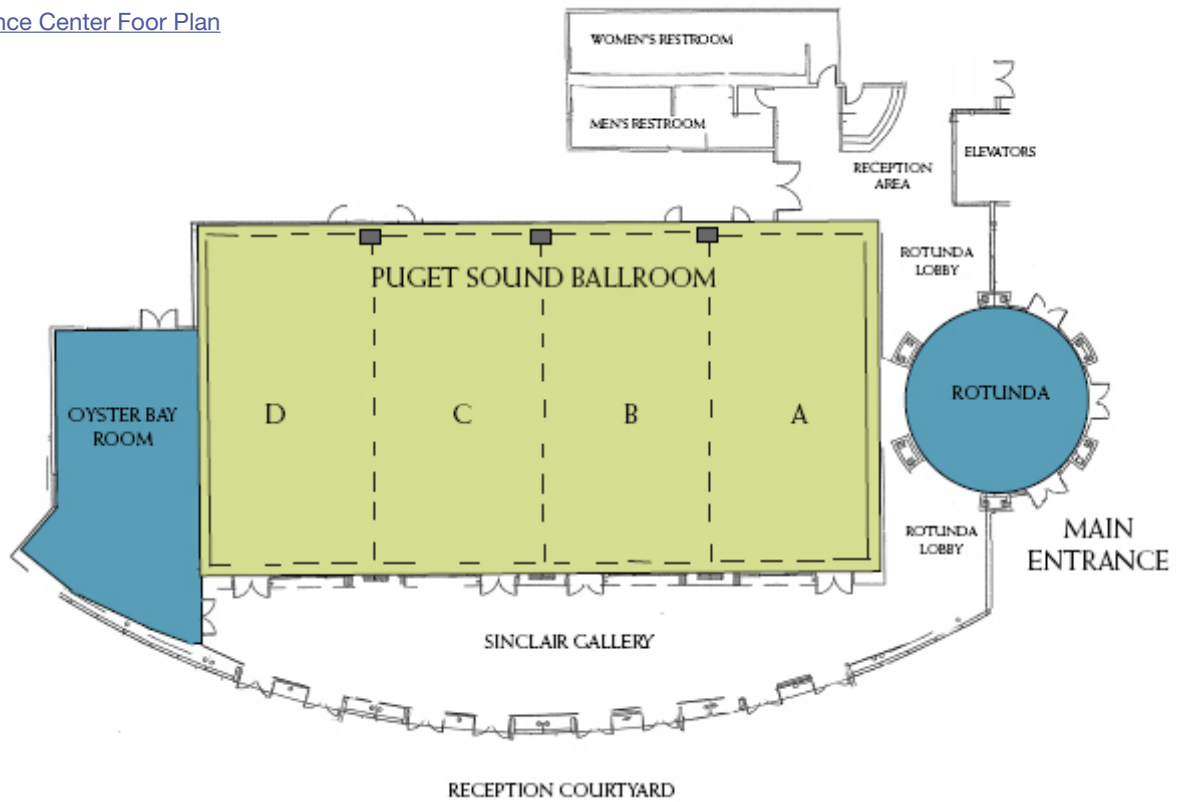

Fountain Room Floor Plan

